

FOLLOW THE STEPS ON THIS PAGE CAREFULLY.

IT'S IMPORTANT TO PUT THE 1/2" LOCK PIN THROUGH THE HOLES IN THE RESTRAINT BRACKET AND THE HITCH CONNECTOR BEFORE BOLTING THE RESTRAINT BRACKET AND VERTICAL TUBE TOGETHER. THIS WILL ENSURE THAT THE LOCK PIN CAN BE EASILY REMOVED WHEN THE RACK IS ASSEMBLED.

2ND + 3RD HOLES: BOLT VERTICAL TUBE TO RESTRAINT BRACKET (TWO 3" x 1/2" CT BOLTS, WASHERS AND NUTS)

BOTTOM HOLE: PIVOT BOLT

YouTube Instructions

Point your camera at the QR code to watch the build video



Parts List

Count	Comments
6	3" x 1/2" CT BOLT / WASHER x 2 / NUT
5	3/8" x 2.5" BOLT CT / WASHER
5	SR WHEEL HOLDER - REAR
5	WHEEL HOLDER - TOP
10	2.5" x 3/8" BOLT CT / WASHER
1	HITCH CONNECTOR
1	HITCH PIN
1	HITCH PIN SPRING LOCK
1	3" x 1/2" FT BOLT / WASHER

3. INSERT VERTICAL TUBE INTO RESTRAINT BRACKET

2. INSERT 1/2" LOCK PIN THROUGH HOLES IN RESTRAINT BRACKET AND HITCH CONNECTOR BEFORE INSERTING VERTICAL TUBE INTO RESTRAINT BRACKET.

RESTRAINT BRACKET: ALIGN WITH 2ND AND 3RD HOLE IN VERTICAL TUBE

JEEP HITCH CONNECTOR

1. INSERT HITCH TUBE INTO CONNECTOR AND FIRMLY TIGHTEN BOLTS (40 LBS-FT MIN).

1/2" x 3" PIVOT BOLT WITH WASHER

4. PIVOT VERTICAL TUBE AND ALIGN PIVOT BOLT HOLE WITH BOTTOM HOLE IN VERTICAL TUBE. INSERT BOLT AND TIGHTEN FIRMLY (40 LBS-FT MIN.)

ShuttleRack

www.shuttlerack.ca | sales@shuttlerack.ca

Assembly - Hitch

ShuttleRack - 5 Bike

issue date 09/06/20 scale

sheet no. revision

b.1

2.6

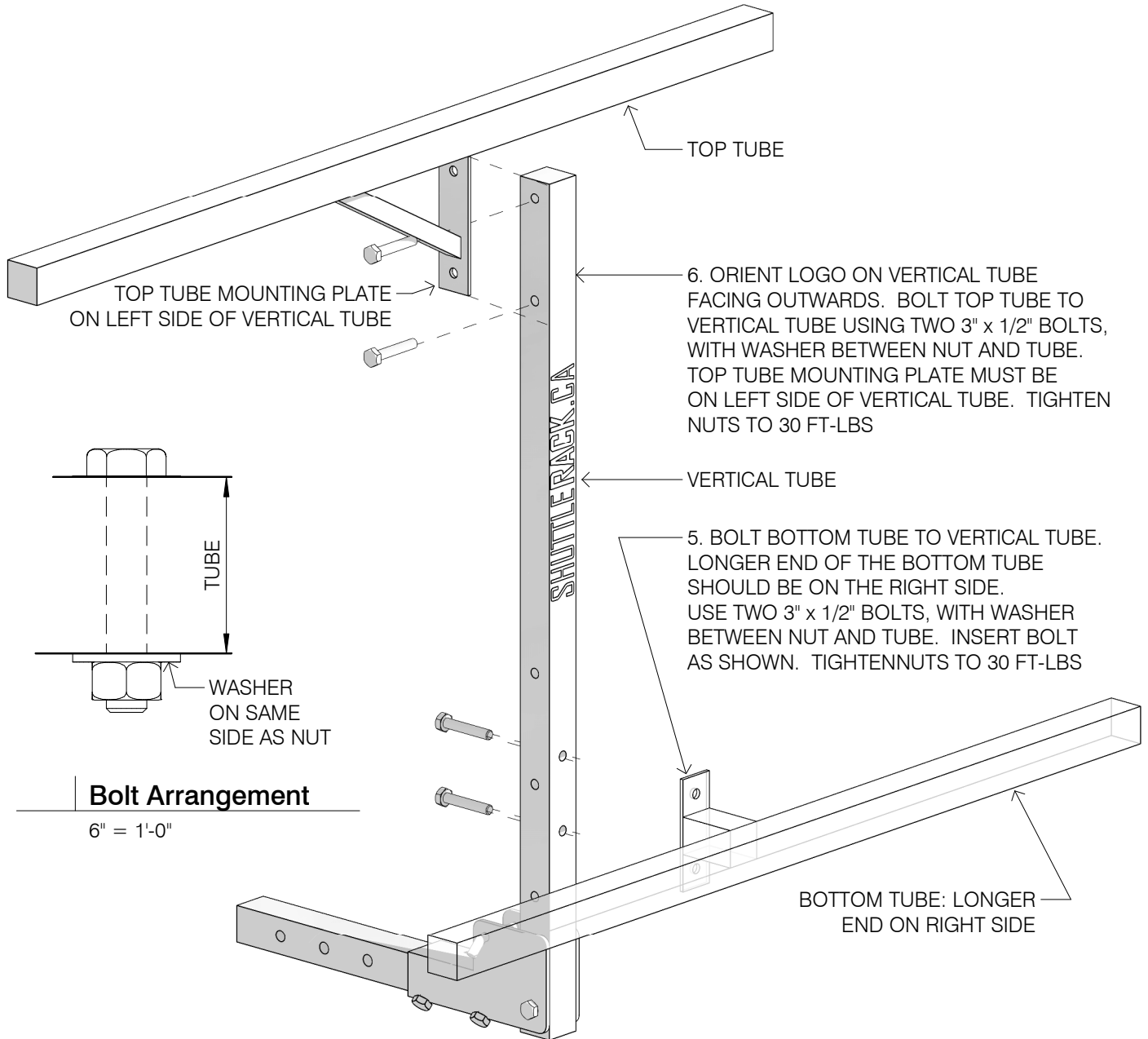

ShuttleRack

www.shuttlerack.ca | sales@shuttlerack.ca

Assembly - Tubes

ShuttleRack - 5 Bike

issue date	scale
09/04/20	6" = 1'-0"
sheet no.	revision

b.2



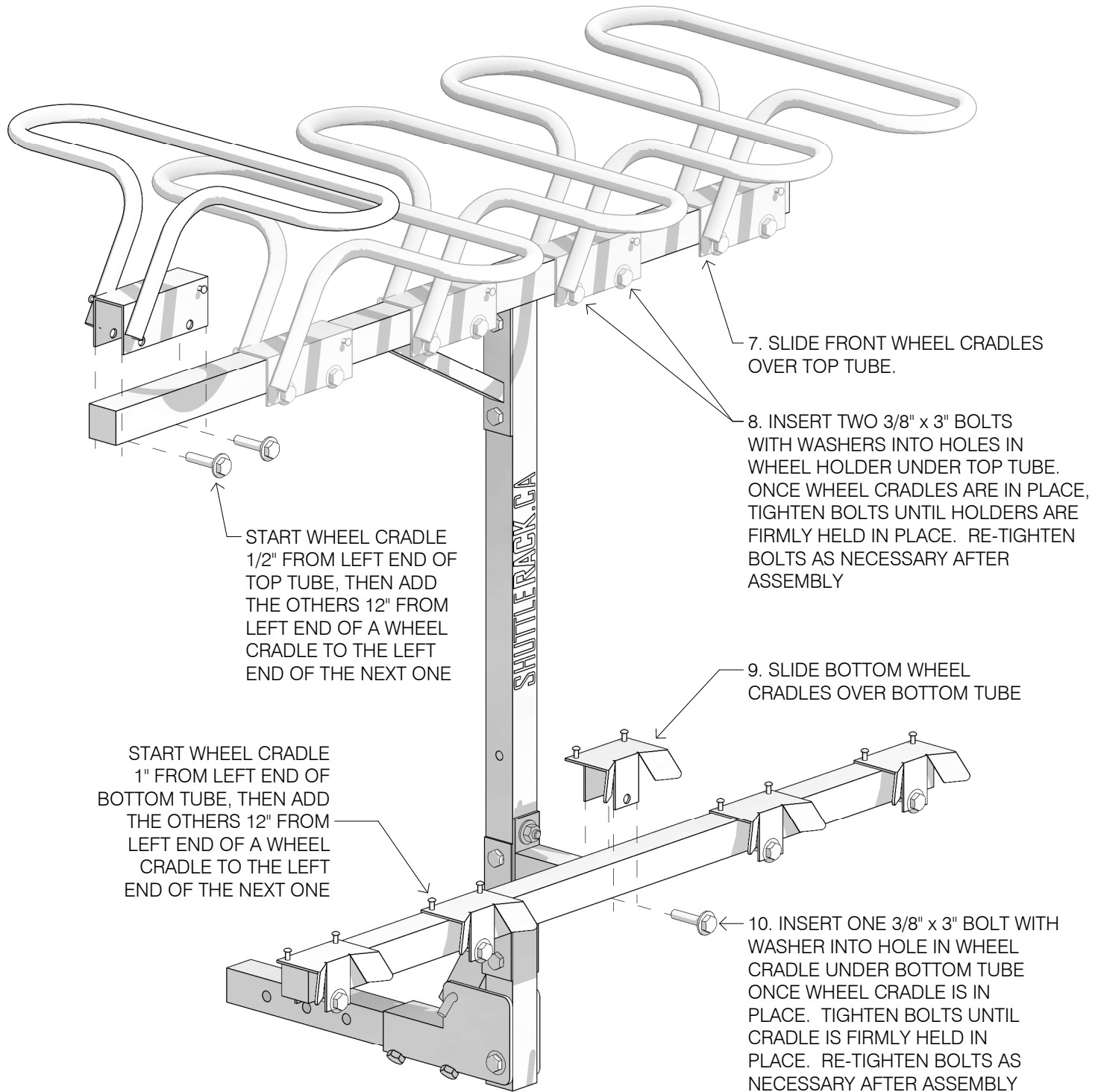

START WHEEL CRADLE 1/2" FROM LEFT END OF TOP TUBE, THEN ADD THE OTHERS 12" FROM LEFT END OF A WHEEL CRADLE TO THE LEFT END OF THE NEXT ONE

START WHEEL CRADLE 1" FROM LEFT END OF BOTTOM TUBE, THEN ADD THE OTHERS 12" FROM LEFT END OF A WHEEL CRADLE TO THE LEFT END OF THE NEXT ONE

7. SLIDE FRONT WHEEL CRADLES OVER TOP TUBE.

8. INSERT TWO 3/8" x 3" BOLTS WITH WASHERS INTO HOLES IN WHEEL HOLDER UNDER TOP TUBE. ONCE WHEEL CRADLES ARE IN PLACE, TIGHTEN BOLTS UNTIL HOLDERS ARE FIRMLY HELD IN PLACE. RE-TIGHTEN BOLTS AS NECESSARY AFTER ASSEMBLY

9. SLIDE BOTTOM WHEEL CRADLES OVER BOTTOM TUBE

10. INSERT ONE 3/8" x 3" BOLT WITH WASHER INTO HOLE IN WHEEL CRADLE UNDER BOTTOM TUBE ONCE WHEEL CRADLE IS IN PLACE. TIGHTEN BOLTS UNTIL CRADLE IS FIRMLY HELD IN PLACE. RE-TIGHTEN BOLTS AS NECESSARY AFTER ASSEMBLY

ShuttleRack
www.shuttlerack.ca | sales@shuttlerack.ca

Assembly - Cradles
 ShuttleRack - 5 Bike

issue date	scale
09/05/20	
sheet no.	revision

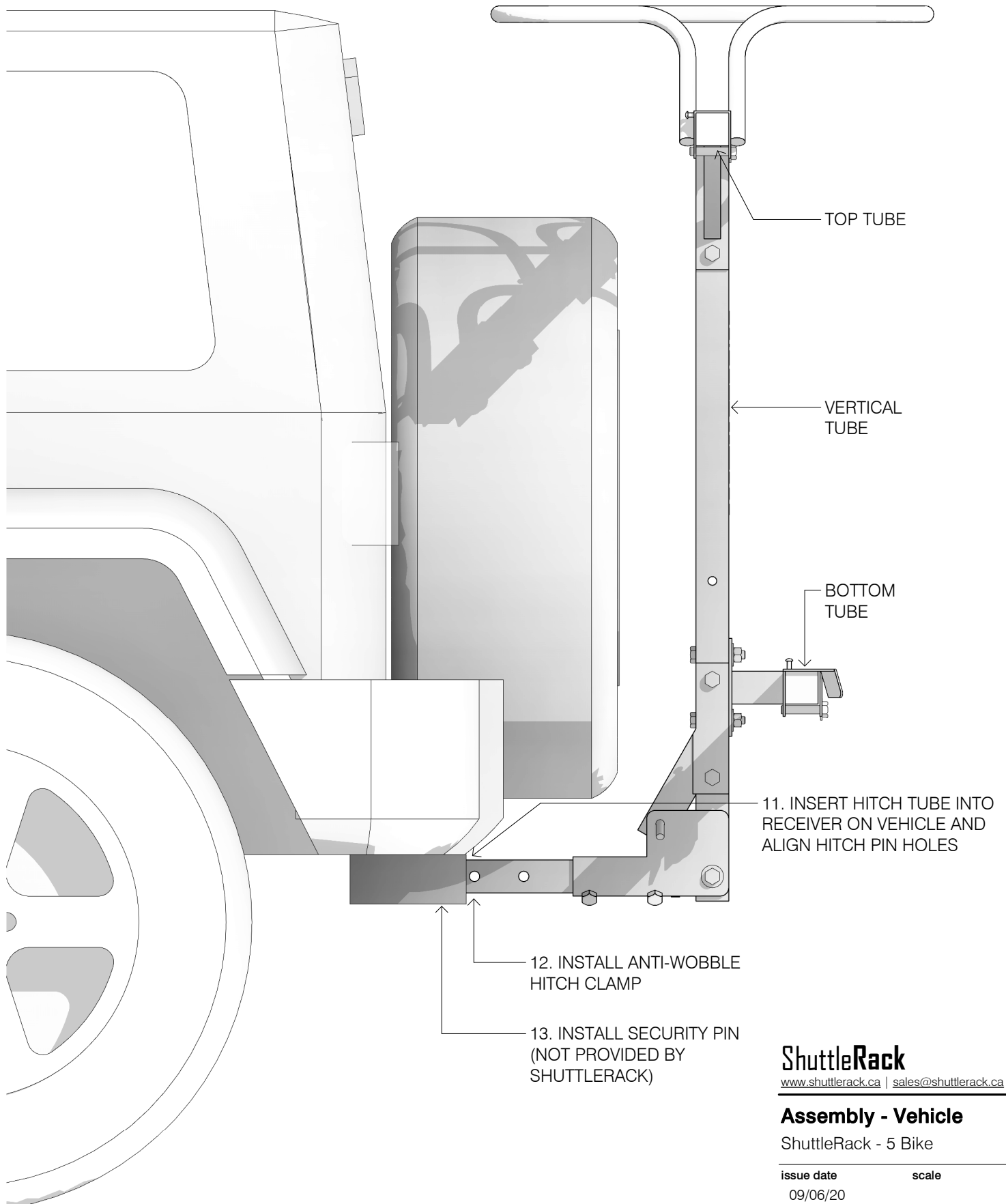

TOP TUBE

VERTICAL TUBE

BOTTOM TUBE

11. INSERT HITCH TUBE INTO RECEIVER ON VEHICLE AND ALIGN HITCH PIN HOLES

12. INSTALL ANTI-WOBBLE HITCH CLAMP

13. INSTALL SECURITY PIN (NOT PROVIDED BY SHUTTLERACK)

ShuttleRack

www.shuttlerack.ca | sales@shuttlerack.ca

Assembly - Vehicle

ShuttleRack - 5 Bike

issue date scale
09/06/20

sheet no. revision

b.4

2.6